

Wheelman Pro Installation Guide

Fit Kit: 810-0031-01

Fits the Following John Deere Vehicles

The vehicles listed in Group A have a rectangular steering console, while the vehicles in Group B have a somewhat square console. Where necessary, this installation guide provides instructions for each group; otherwise, information in this guide applies to both groups.

Group A Vehicles

6000 Models*			6100M Models		7000 Models*			<i>*Standard (non-premium) cab models only for 6000 and 7000 models</i>
6100	6310	6600	6105M	6145M	7130	7400	7600	
6110	6320	6610	6110M	6150M	7200	7410	7610	
6120	6330	6620	6115M	6155M	7210	7420	7700	
6130	6400	6800	6120M	6170M	7220	7430	7710	
6200	6410	6810	6125M	6175M	7230	7510	7800	
6210	6420	6820	6130M	6195M	7320	7520	7810	
6220	6430	6910	6140M		7330			
6230	6520	6920						
6300								

Group B Vehicles

7000 Models			8000 Models		8000R Models		9000 Models		
7630	7820	7920	8100	8310	8225R	8295R	9100	9300	9430
7720	7830	7930	8110	8320	8235R	8310R	9120	9320	9520
7730			8120	8330	8245R	8320R	9200	9330	9530
			8130	8400	8260R	8335R	9220	9400	9620
			8200	8410	8270R	8345R	9230	9420	9630
			8210	8420	8285R	8360R			
			8220	8430					
			8230	8520					
			8300	8530					

How to Use This Guide

This installation guide lists all the parts and provides instructions on how to install Wheelman Pro on the above vehicles. Read this manual thoroughly before beginning the installation.

- 1 Read and understand all safety warnings - page 2
- 2 Review the list of tools/items you may need to install Wheelman Pro - page 2
- 3 Review how your Wheelman Pro parts fit together - starting on page 3
- 4 Install Wheelman Pro - starting on page 6

1 Safety Information

As the operator of the vehicle, you are responsible for its safe operation. The autosteering system is not designed to replace the vehicle's operator. After installation, ensure all screws, bolts, nuts, and cable connections are tight and all cables have been secured to prevent them from being damaged.

The warnings starting below and those throughout this manual (indicated by either graphic at right) provide information to identify hazards associated with potential injury or death and tell you how to avoid them.



Read and understand this manual and all the warnings below before installing, operating, or performing maintenance or service. **FAILURE TO DO SO MAY CAUSE IRREVERSIBLE DAMAGE TO YOUR SYSTEM.** Keep this manual and all related safety information with the manuals for your vehicle. For questions or further assistance, contact Customer Support.

Safety Information and Warnings



To understand the potential hazards associated with the operation of an autosteer equipped vehicle, read the provided documentation before installing or operating the autosteering system.



To prevent accidental death or injury from being run over by the vehicle or automated motion of the steering system, never leave the vehicle's operator seat with autosteering engaged.



To prevent accidental death or injury from being run over by the vehicle, verify that area around the vehicle is clear of people and obstacles before startup, calibration, tuning, or use of autosteering.



To prevent the accidental engagement of autosteering and loss of vehicle control while driving on roads, shut down autosteering. Never drive on roads or in public areas with autosteering powered up.



To prevent accidental falls, maintain a stable position on the vehicle's platform or stairs when installing or removing the GPS antenna. If the vehicle does not provide a safe platform, use a ladder to safely access the vehicle's roof.



To avoid electrical shock hazards, remove the GPS antenna and/or other antennas from the vehicle before driving under low structures or low electrical power lines.

2 Tools/Items Needed for Installation

Make sure you have the right tools, such as:

- Wrenches, socket set, and screwdrivers
- Hex keys (4 mm and 5 mm)
- Hammer or steering wheel puller
- Torque wrench (in-lb)
- Blue threadlocker (medium strength)
- Tape measure (for vehicle measurements)

3 Parts for Your Installation

Use the diagrams that follow to:

- Below - verify you have all Wheelman Pro parts
- Page 4 - see an overview of cable connections
- Page 5 - see how the parts in the dotted rectangle below fit together on your steering column

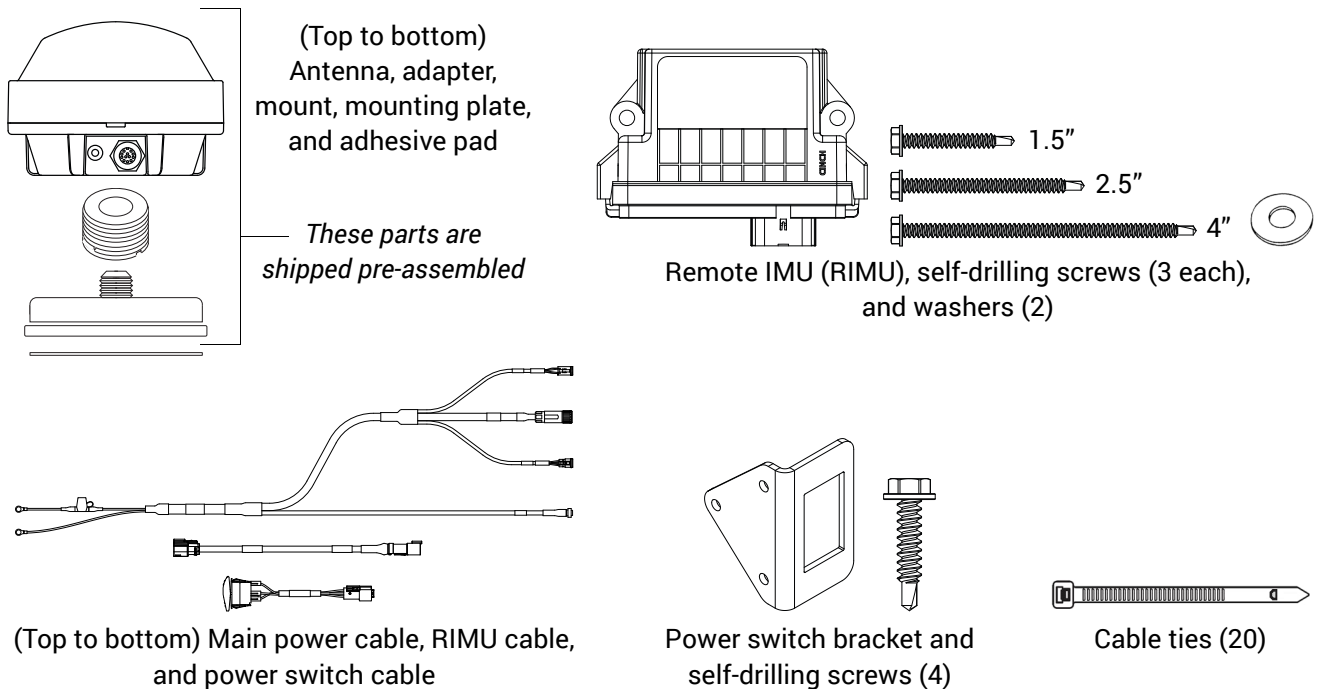
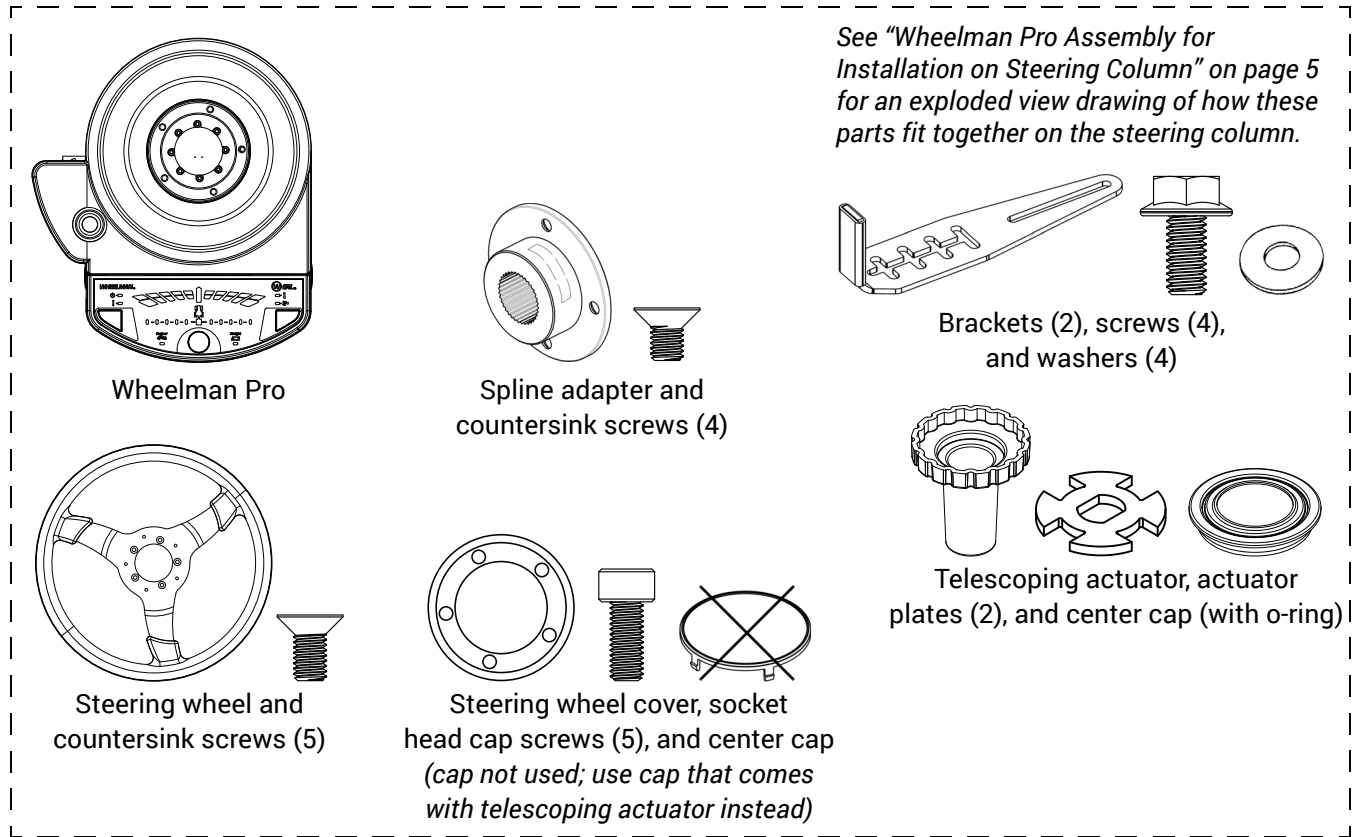

Wheelman Pro Connection Diagram

Review the diagram below to see how the Wheelman Pro parts are connected using the cables. The diagrams on the next page show how the Wheelman Pro is assembled on the steering column.

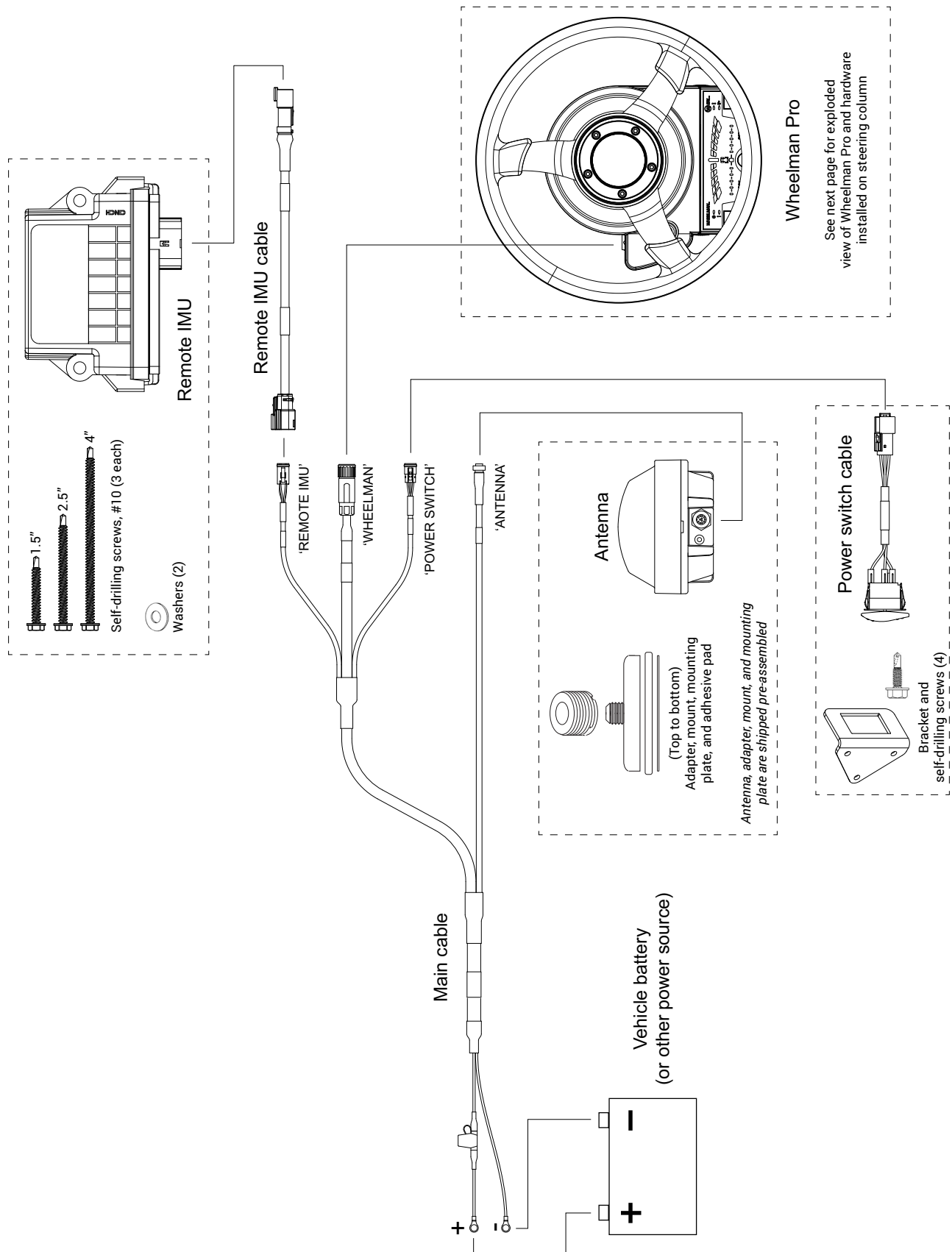

Wheelman Pro Assembly for Installation on Steering Column

Use the figures below to help you assemble Wheelman Pro as described in the instructions starting on the next page.

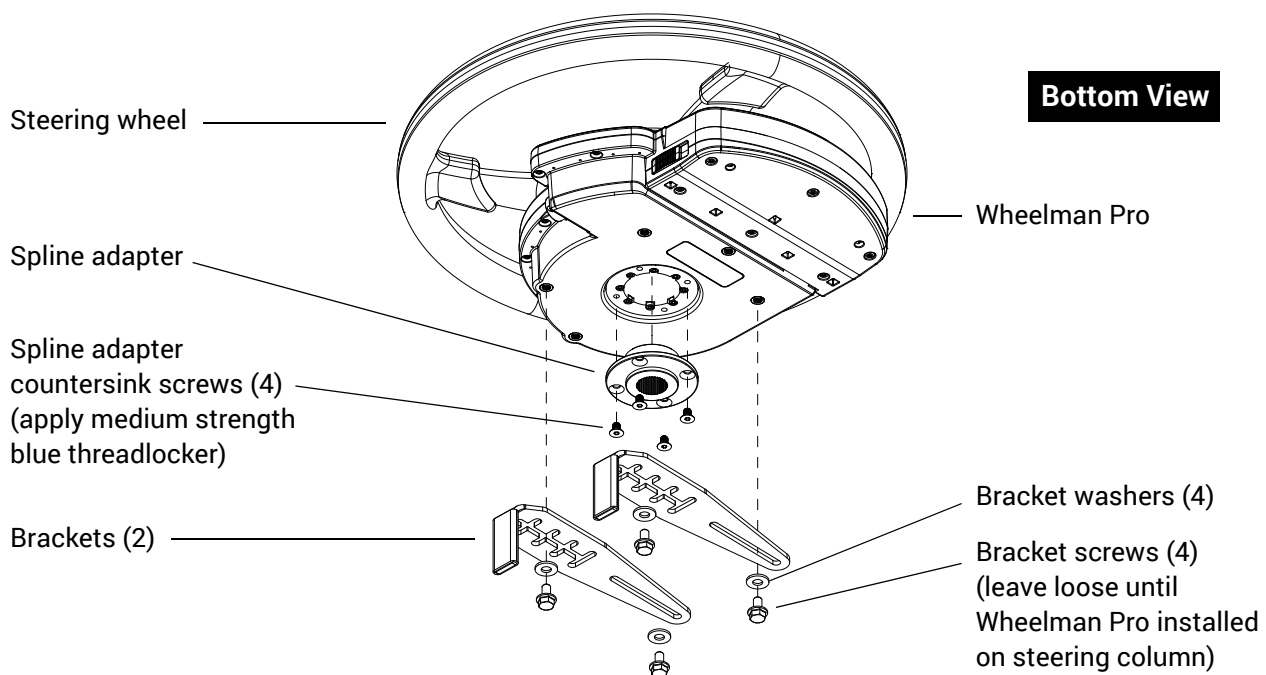
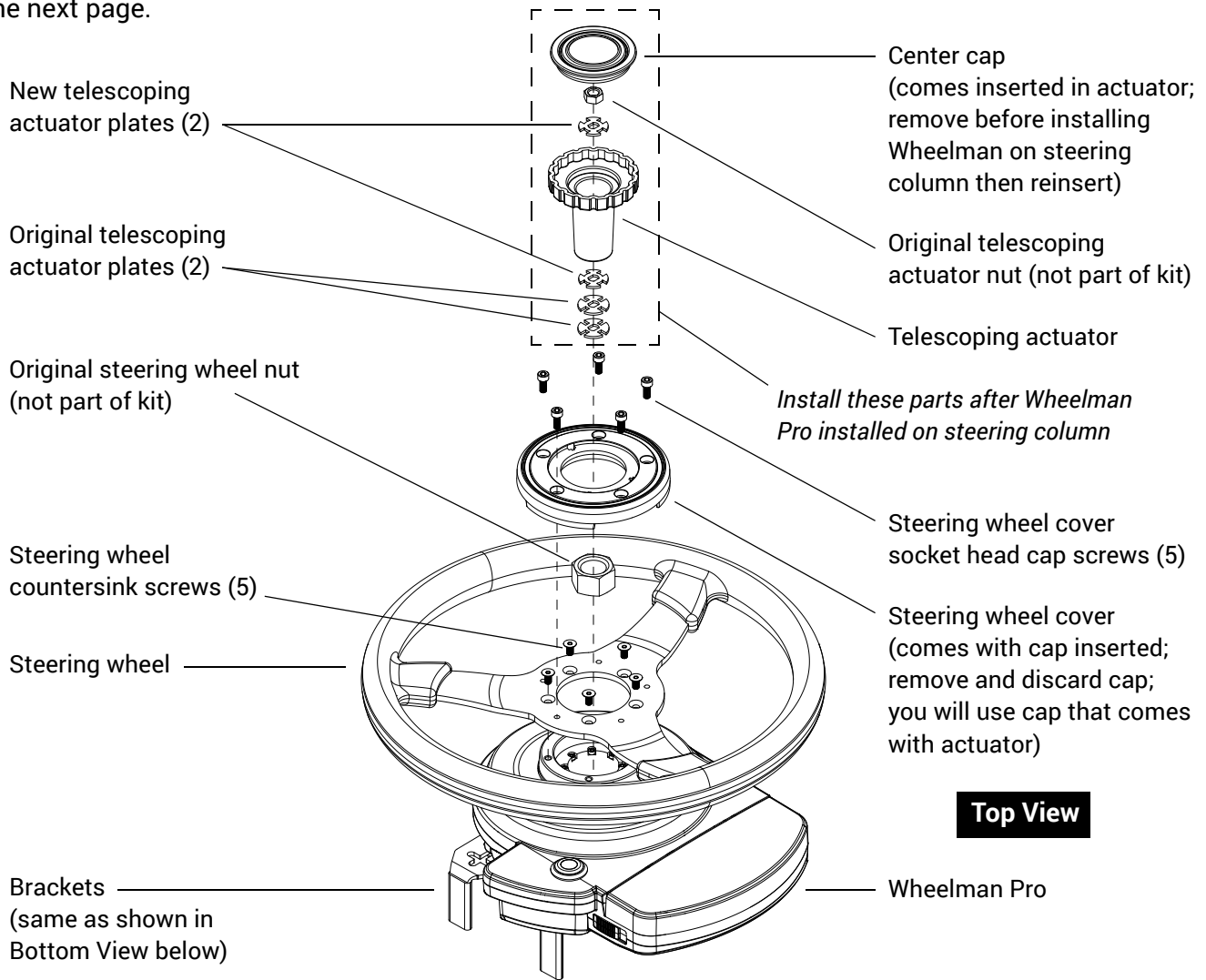

4 Install Wheelman Pro

Using the diagrams on the previous pages as a reference, complete this section to install Wheelman Pro on your vehicle.

NOTE:

Before beginning the installation:

- On a clean surface lay out all the components and check them against the diagram on the previous pages.
- Become familiar with the components and where they are to be installed.
- Work out how the harness is to be routed into/out of the cab (typically, through the rear window for closed cabs) to the battery and antenna. It is recommended to start at the battery and work back into the cab.

a Assemble the components that you will install on the steering column

You may want to perform these steps on a flat surface, such as a work bench. These steps show installing the following on the Wheelman Pro: spline adapter, then brackets, and finally the wheel; however, you may install them in any order. You can then install this assembly as one piece on the steering column in section c on page 9.

Using the parts overview on page 3, the assembly diagram on page 5, and the photos that follow as reference, assemble the components while noting the following:

- Leave the brackets loose—you will tighten these later.
- Do not install the telescoping assembly yet—you will install the appropriate parts later.

1. On the underside of the Wheelman Pro, install the spline adapter and the brackets:
 - a. Apply blue threadlocker to the four spline adapter countersink screws, then using the screws and a hex key, install the spline adapter on the bottom of Wheelman Pro. Torque the screws to 50 in-lb.
 - b. Using the four bracket screws and four bracket washers, attach the two brackets as shown below; leave the screws loose (do not tighten).

Group A Example

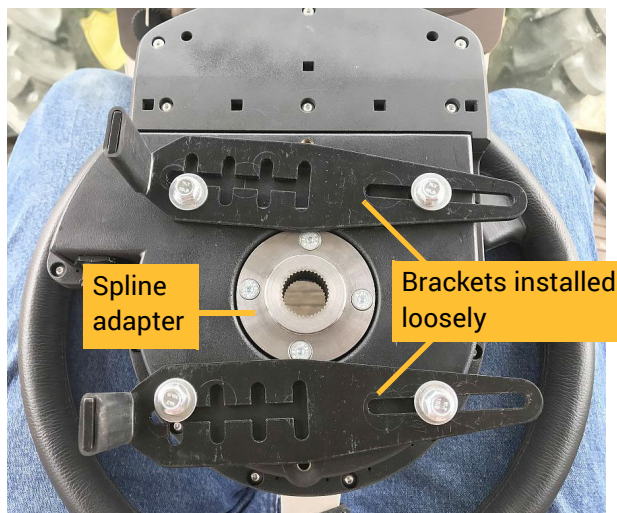

Group B Example

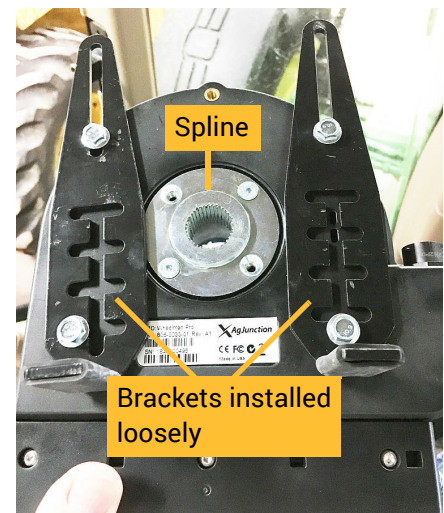

2. On the top side of the Wheelman Pro, install the new steering wheel (below left) and the steering wheel cover (below right)—although the photos below show the Wheelman already placed on the steering column, you may assemble these components on a flat surface, such as a workbench, before installing the assembly on the steering column. If you want to assemble these components while installing Wheelman on the steering column, complete step b below (removing the existing steering wheel) first.
 - a. Place the new steering wheel on top of the Wheelman Pro, then using the five countersink screws that came with the steering wheel, fasten the wheel to the Wheelman Pro.
 - b. Carefully pop the Wheelman center cap out of the steering wheel cover and discard the cap—you will instead use the cap that is preinserted in the telescoping actuator. Using the five socket head cap screws, install the steering wheel cover. Do not overtighten.



b Remove the existing steering wheel

1. Remove and discard the steering wheel center cap (below left) and telescoping actuator nut (below right).
2. Remove and retain the two telescoping actuator plates (below right)—you may need to reuse them later.
3. Remove and discard the telescoping actuator (below right).

Group A
Example

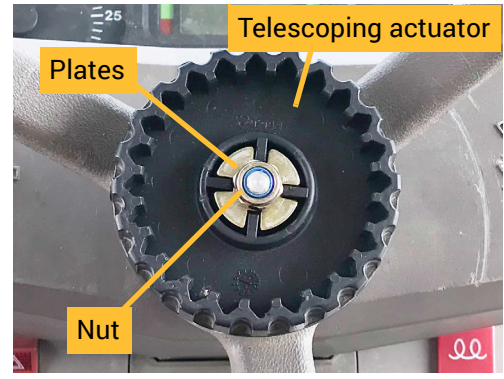

Group B
Example

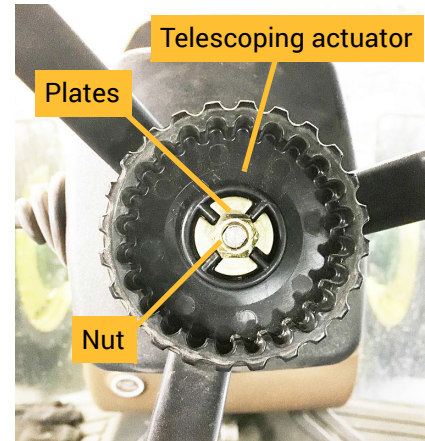
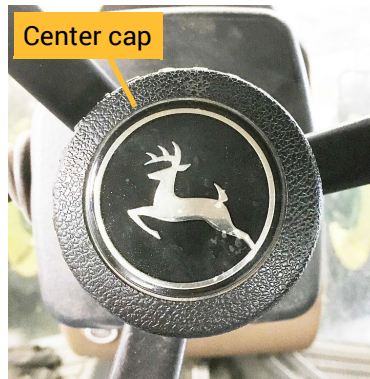

4. Remove and retain the steering wheel nut (below left and middle)—you will reuse it later.
5. Using a steering wheel puller, rubber mallet, or suitable tool, remove the steering wheel (below right). If necessary, consult your equipment dealer if you are unsure of the correct procedure for removing the steering wheel.

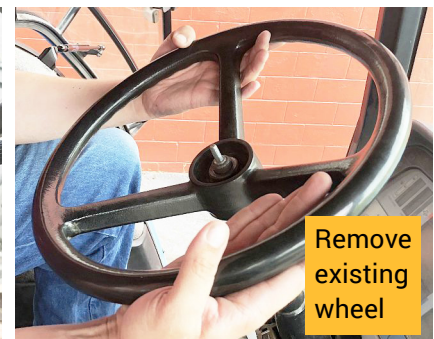

C Install the Wheelman Pro assembly on the steering column

1. Place the Wheelman Pro assembly (from section a) on the steering column with the power button and connector to the left of the steering column (near the 9 o'clock position).

Group A Example

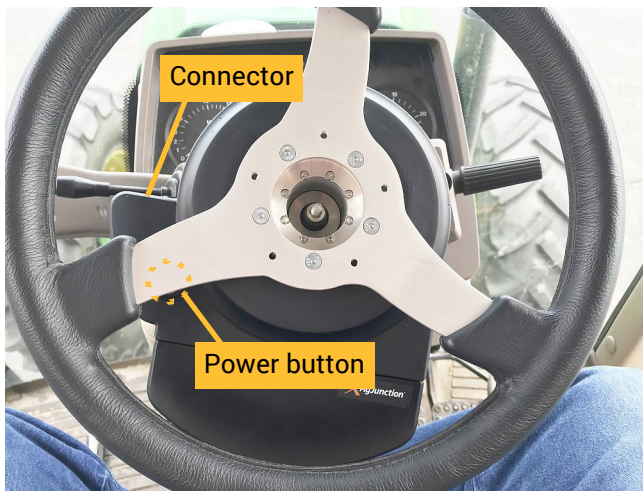

Group B Example



NOTE:

When completing the next step, make sure the brackets are snug against the steering console and that there is proper clearance between Wheelman components and vehicle levers and switches for proper operation.

2. Push the two bracket tabs against the upper and lower left of the steering column housing then torque the bracket screws with a 10 mm wrench to 50 in-lb.

Group A Example

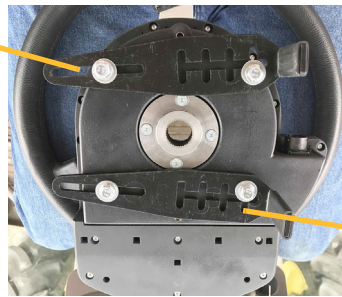
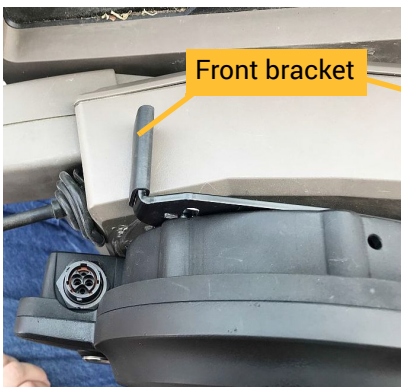

Group B Example

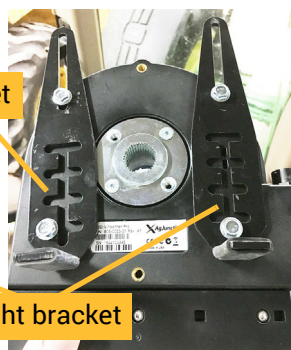
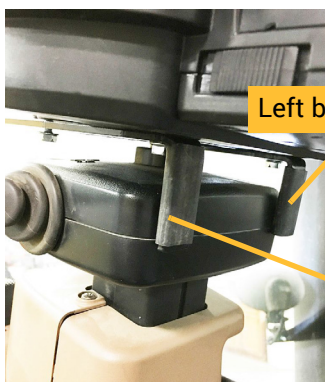

- Using the steering wheel nut from when you removed the old steering wheel, secure the Wheelman Pro to the steering column. Tighten the nut. **DO NOT OVERTIGHTEN.**

NOTE:

In step 4 that follows, you may use none, one, or both of the original telescoping actuator plates (that you removed in section b on page 8) before installing the nut. You will use however many are necessary to provide the proper spacing when installing the telescoping assembly. You may discover this by trying each option (none, one, or two plates) before installing and tightening the telescoping actuator nut in step 5 below.

- Install the telescoping actuator plates on the steering column—you may need to use the original plates (see NOTE above). However many original plates you use, the top plate must always be one of the new actuator plates.

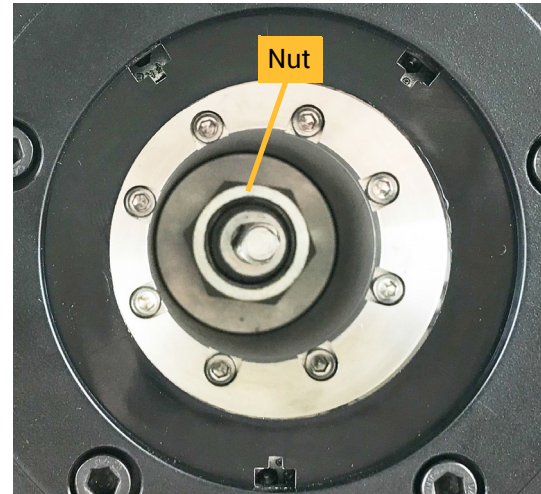
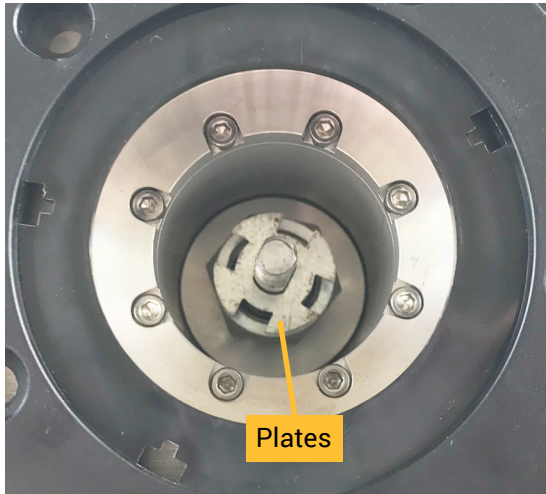

- Install the new telescoping actuator on the steering column (below left), install the other new actuator plate in the center of the actuator on the steering column, then using the original telescoping actuator nut secure the telescoping actuator to the steering column. **DO NOT OVERTIGHTEN.**
- Snap the center cap into the steering wheel cover (below right).

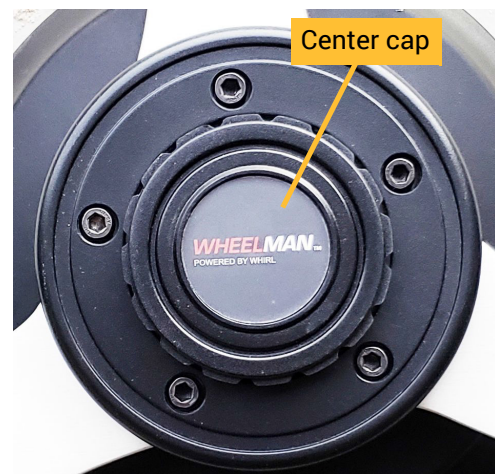
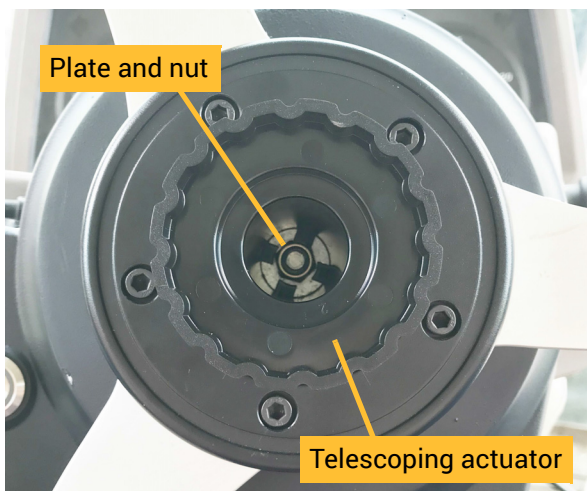

d Install the Remote IMU (RIMU)

The Remote IMU (sometimes referred to as a gyro, but actually contains a set of gyros and accelerometers) measures your vehicle's movement in all directions to enable Wheelman to more precisely autosteer your vehicle.

⚠ WARNING: Before drilling (or using self-drilling screws) in the cab, make sure there is nothing that can be damaged by the drilling or by any self-drilling screws used to secure the RIMU. Secure anything that could be damaged away from where the screws come through. The photo at right is an example of a pre-drilling check; it shows an under-floor cabling compartment.



When installing the Remote IMU (RIMU):

- The mounting location must be solid to the vehicle frame or cab and be vibration-free.
- The RIMU must not move independently of the vehicle (not loose on the cab floor).
- The RIMU must be square to the floor and to the centerline of the vehicle.
- There must be sufficient clearance around the seat to accommodate the RIMU as the seat suspension moves up and down even with the seat at its lowest level (for example, with all the air removed).
- There must be sufficient clearance to rotate the seat without interfering with the RIMU.
- Do not mount the RIMU where it can:
 - Interfere with any of the vehicle's seat or other control levers and knobs.
 - Interfere with the operator's visibility while operating the vehicle.
 - Be damaged by falling objects or where other materials can be piled on it.

To install the Remote IMU:

1. Review the requirements above.
2. Using the two self-tapping hex screws and washers, install the RIMU in your preferred location. Do not overtighten.

The photo at right shows the RIMU installed on the cab floor, to the right of the operator's seat, with the X-Y label pointing up, and with the connector pointing toward the rear. **You will enter the label and cable directions during vehicle setup in the Whirl app.**

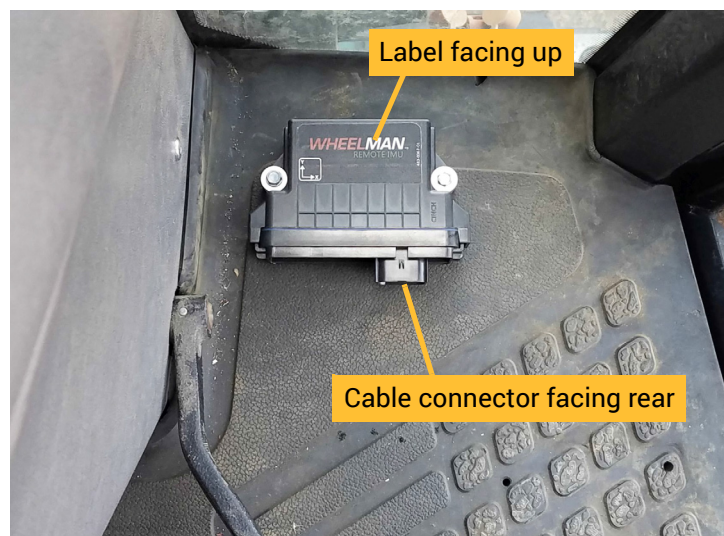

e Mount the antenna on the vehicle roof

The antenna, adapter, and mount (at right) are shipped pre-assembled.

Once you place the mounting plate on the vehicle roof, you will not be able to move it. Therefore, plan your antenna location carefully.

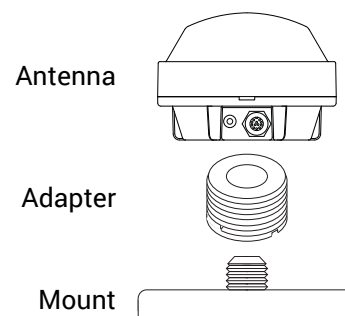

To mount the antenna on the vehicle roof:

1. Clean and dry the vehicle surface where you will attach the antenna mounting plate.
2. Remove the paper backing from the adhesive on the back of the mounting plate (see photo at right).



3. Position the mounting plate and press down hard for proper adhesion. When determining the location of the mounting plate, ensure that when you mount the antenna on the plate (next step) the antenna will be on the vehicle's centerline and pivot line.

NOTE:

Depending on your vehicle, if you cannot place the antenna on the centerline and/or pivot line, place the antenna as close as possible to these lines.

Measure the antenna left/right offset (distance left or right of centerline of antenna center) and the antenna pivot (distance front or rear of pivot line of antenna center). You will enter these values in the Whirl app during vehicle setup.

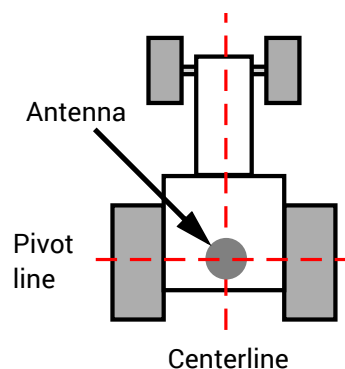

4. Ensure the antenna assembly (antenna, adapter, mount) is securely tightened, then place the assembly on the mounting plate (see photo at right).



f Route and connect the cables

Using the “Wheelman Pro Connection Diagram” on page 4 as a guide, connect the cables included in your kit (main cable, Remote IMU cable, power switch cable) to the appropriate parts.

When routing cables:

- Stow cabling under carpets and at the edges of the cab.
- Store excess cable lengths with a minimum six-inch bend radius.
- Avoid high-temperature exposure (for example the exhaust, exhaust manifold).
- Hand tighten cables only—do not use tools.
- When connecting the main cable to the antenna, note the nub on the antenna’s connector and the notch on the cable end (see near right). To connect the cable, align the notch with the nub, push the cable onto the antenna connector, then twist to the right to lock it in place (see far right).

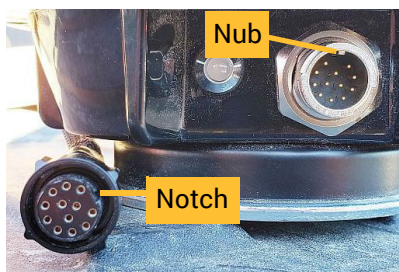

NOTE:

Some machines are equipped with pop out tabs that you can remove and replace with the power switch (see near right). If no tab is available, you can use the power switch bracket (see far right), mounting it in the cab in your preferred location. Turn the power switch off before connecting the main cable to the battery.



Congratulations on successfully installing your Wheelman Pro. Return to the Quick Start Guide to finish setup.